

*Mega*  
**HORNET**  3000

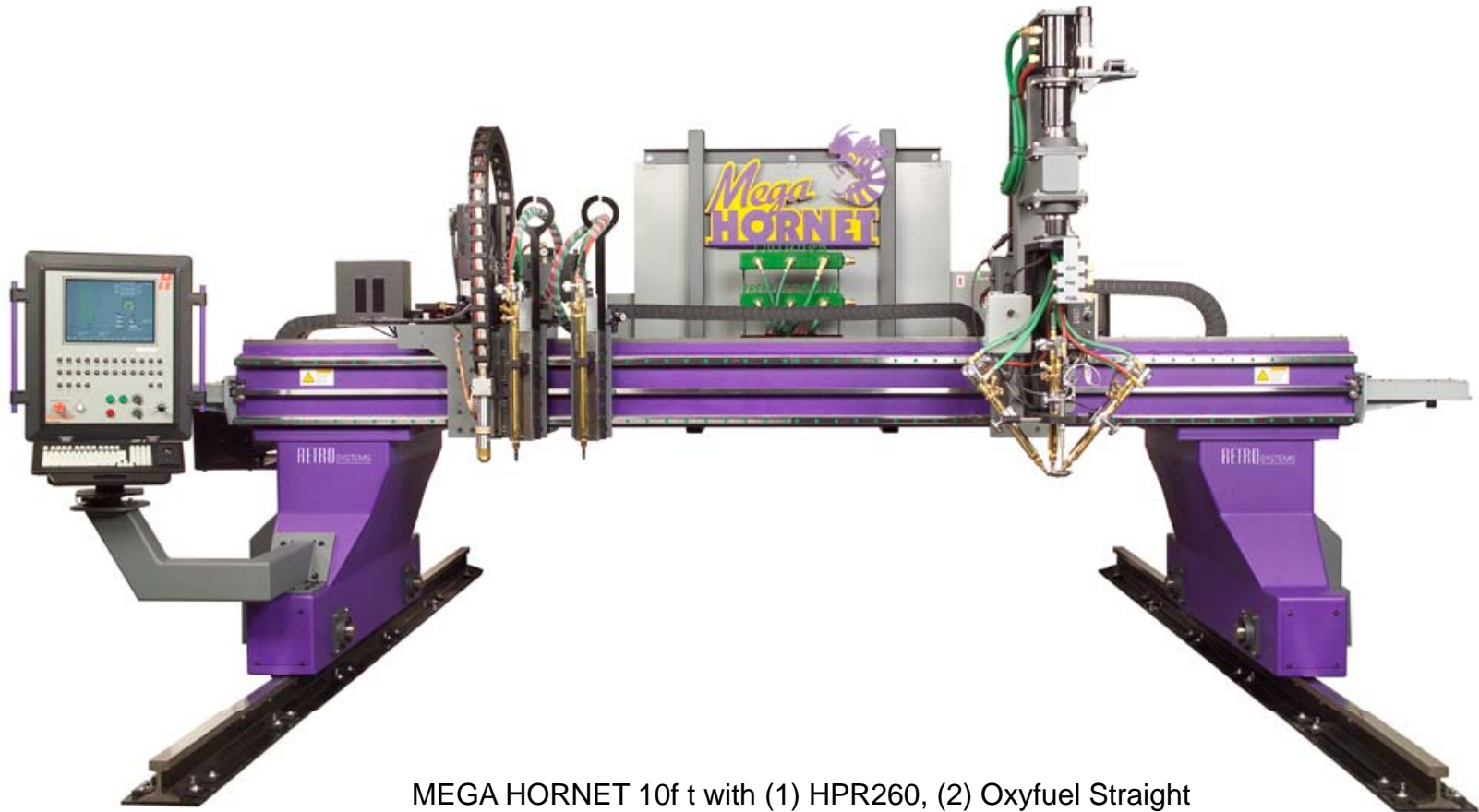



MEGA HORNET 10f t with (1) HPR260, (2) Oxyfuel Straight cutting stations & (1) Infinitely Rotating Triple Bevel Head



## MEGA HORNET

- Available in 10 ft to 30 ft widths
- Lengths of over 100 ft can be supplied

### TYPICAL END USER TYPE:

- Steel service center / Machinery manufacturer / Shipyard

### TYPICAL PRICE RANGE:

- \$200,000 plus

### FEATURES:

- **Hypertherm FULL SUITE** of products in support of **TRUE HOLE™ Technology**
- **Hypertherm EDGE Pro** CNC Control with **Phoenix** CNC software
- **SERCOS** Fiber Optic Drive Control Interface
- Triple Machined Floor Mounted Rail System
- SENSOR-5 Plasma Torch Height Control Software
- RSVS-5 Plasma Torch Lifter with RAD Plasma Collision Mount
- Dual Linear Ways on Cross Axis
- 7,700 Watt (10 HP) AC Servo Motors and Amplifiers
- Planetary gear heads (5 arc minute)
- 600 IPM contouring & 1,000 traverse speed
- Over Head or Floor Mounted Flexible Cable Carriers for All Cables and Hoses

### OPTIONS:

- Up to (4) Plasma systems (Conventional or High Definition)
- Up to (12) Oxy-fuel Straight Cutting torch stations
- Up to (2) Oxy-fuel Triple Bevel Cutting torch stations
- Heavy Duty Hi/Low Pre-Heat Oxy-fuel Gas Manifold
- Zoned & Ducted Center-Draft air exhaust table & Dust Collection Systems
- Water Tables with Adjustable Water Level
- MTC Nesting Software





EDGE Pro CNC control with version 9 software to support TRUE HOLE™ technology



12mm hole cut in 12mm steel without TRUE HOLE™ Technology



Taper is evident. The top of the hole is noticeably larger than the bottom.

12mm hole cut in 12mm steel with TRUE HOLE™ Technology



Taper is virtually eliminated. And the "Ding" is reduced and biased to outside of the hole.

Both holes cut with HPRXD plasma system



**Hypertherm**<sup>®</sup>  
HyPerformance<sup>®</sup> Plasma



HPR260xD



HPR400xD



### HPR400xD Plasma Torch Consumables

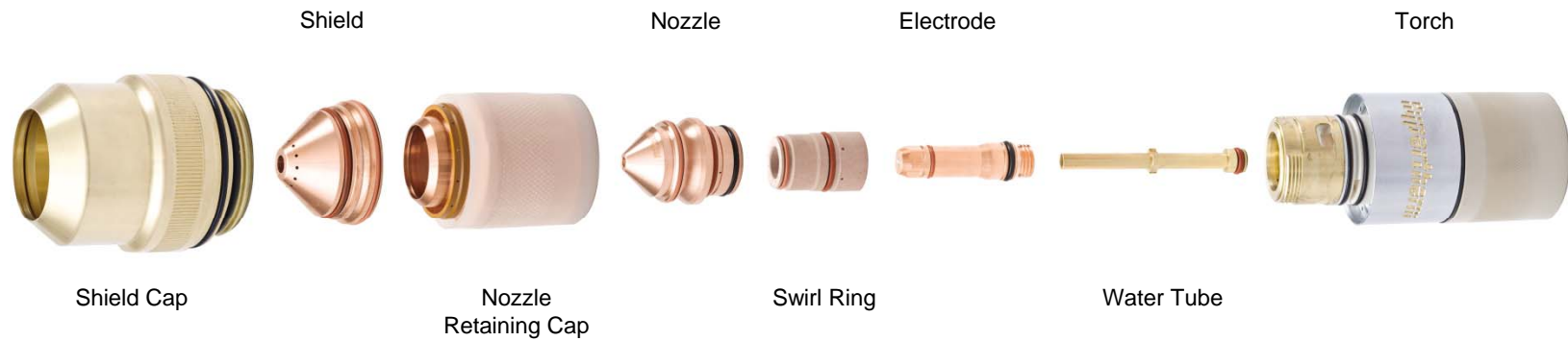



2" (50mm) steel and thin stainless steel





Piercing & Cutting 2" (50mm) Steel

2" (50mm) Steel

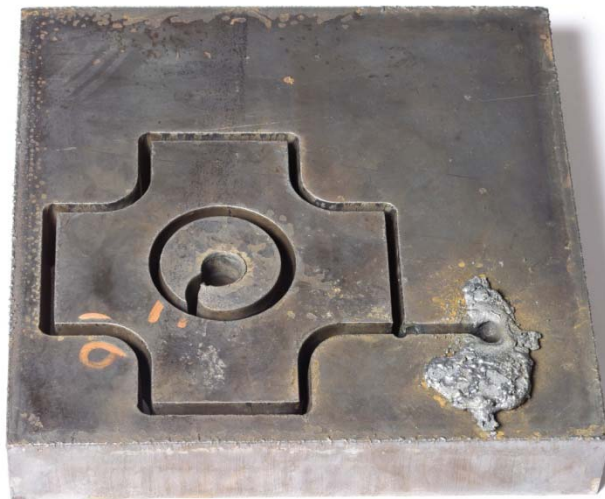



Master side end truck





Rear view of machine



**Mariner** CNC Control

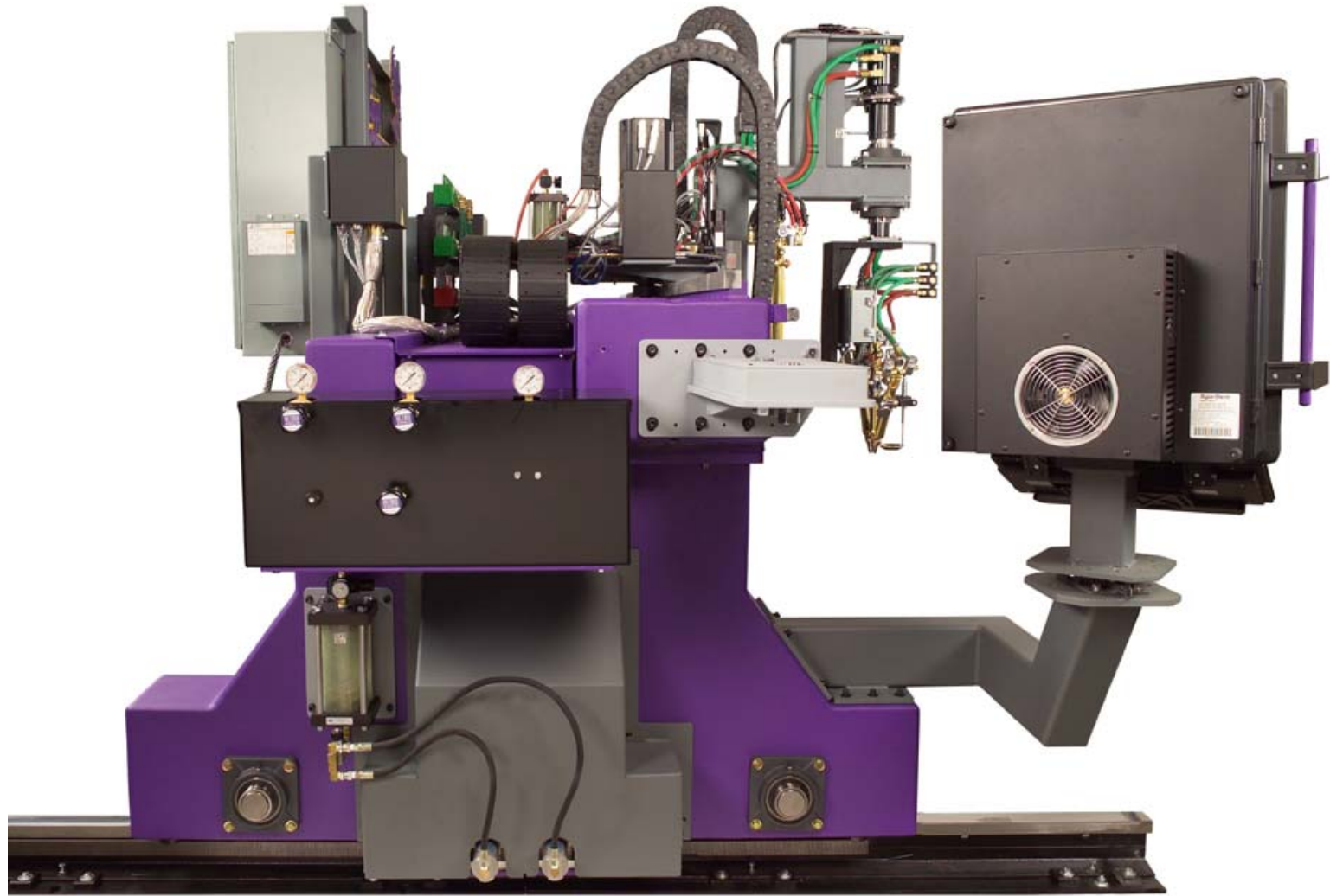

View of master side machine frame





Slave side view of machine frame





3/8" thick steel plate construction

End truck with motor cover removed





3/8" thick steel  
plate construction

End truck with motor cover in place



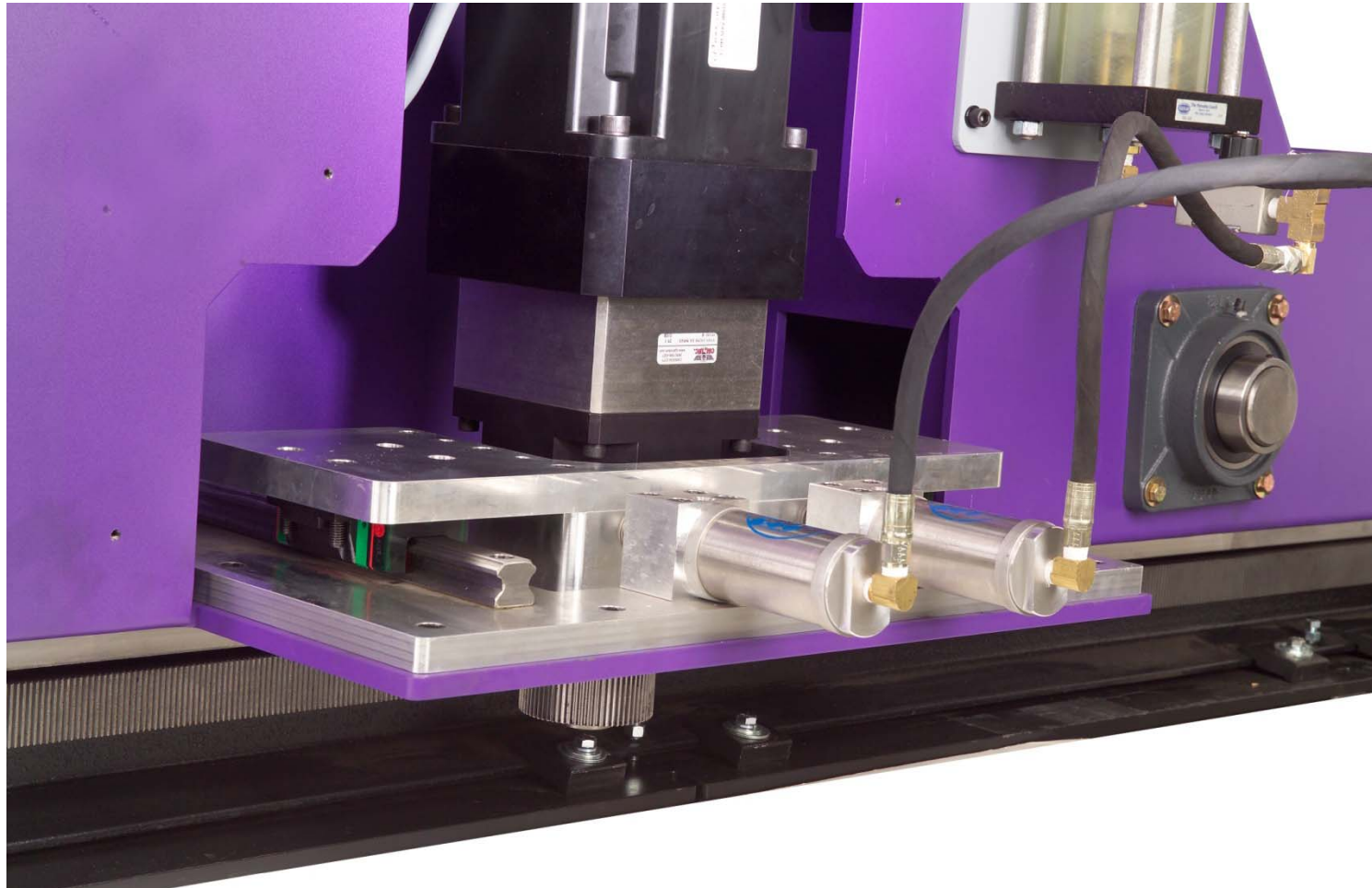

Main rail motor mount with air pressure over oil pressure and twin linear ways



End truck with  
cover removed  
showing truck  
wheel and axle

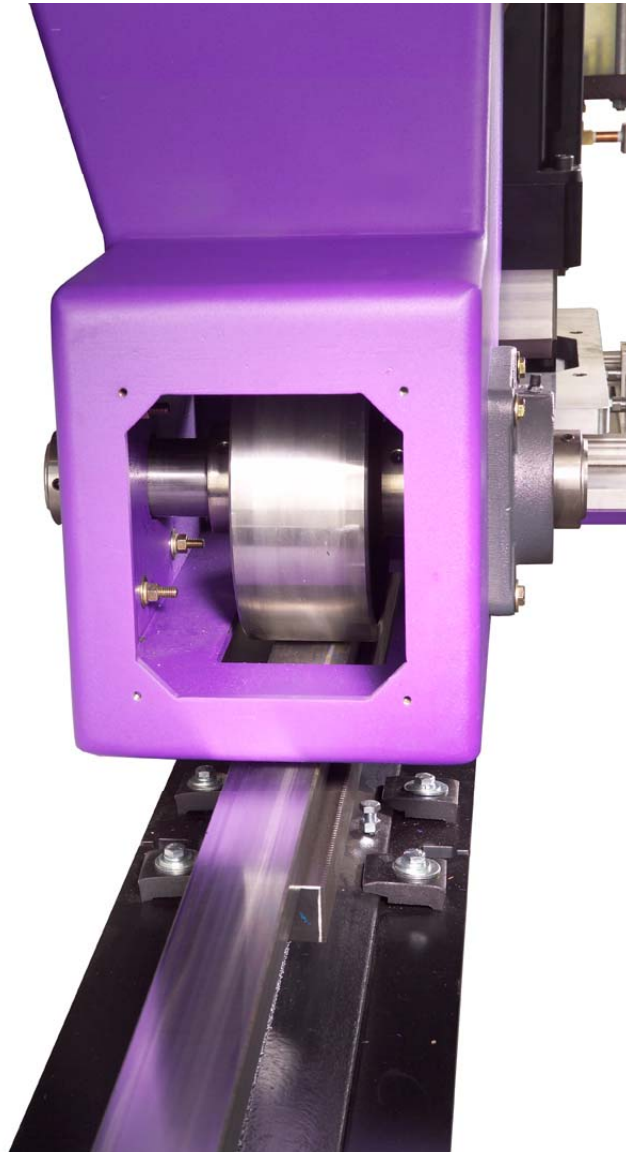



Twin large diameter band drive wheels



Band drive system

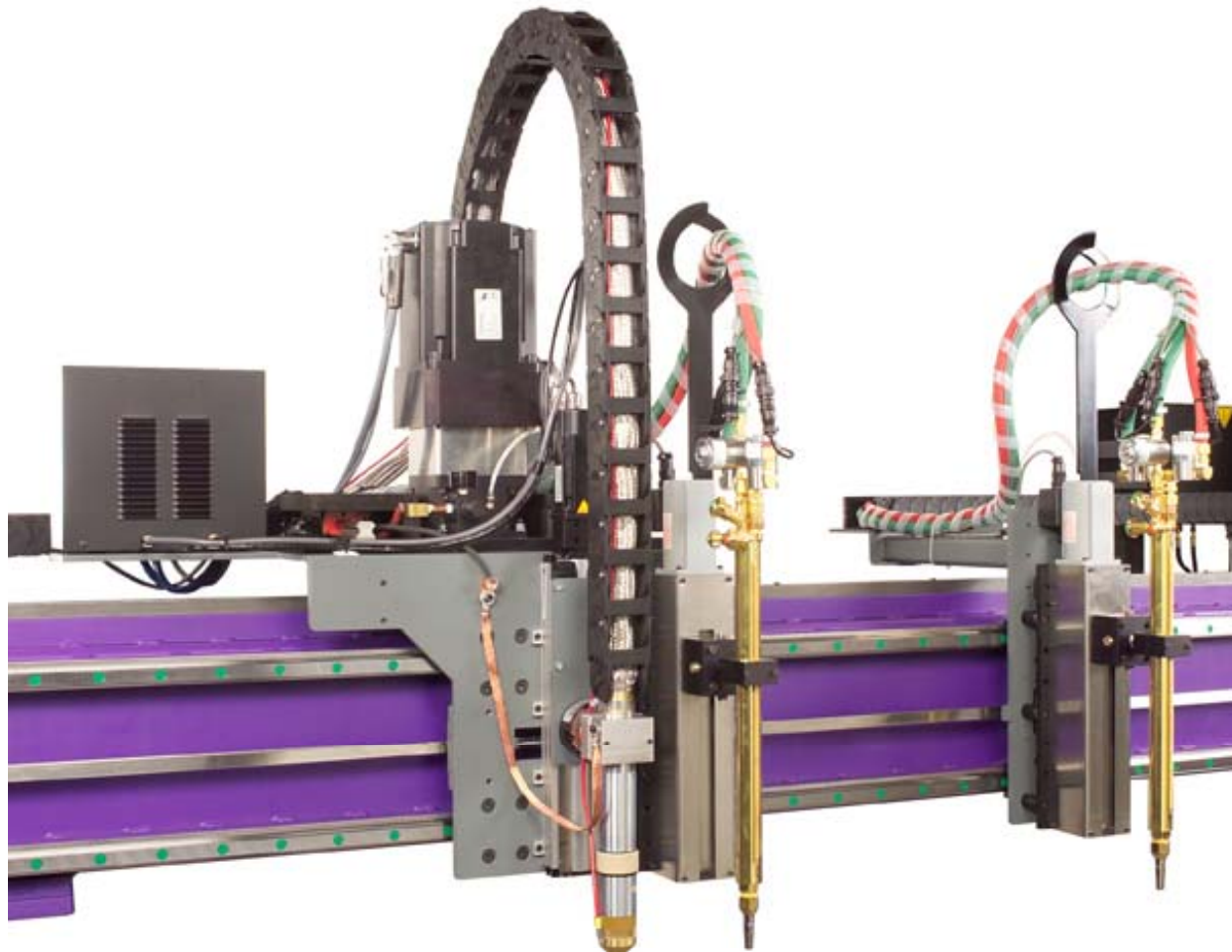

Master carriage with (1) plasma and (1) Oxy-fuel station and (1) Slave Carriage



Infinitely Rotating Triple  
Bevel Oxyfuel Head

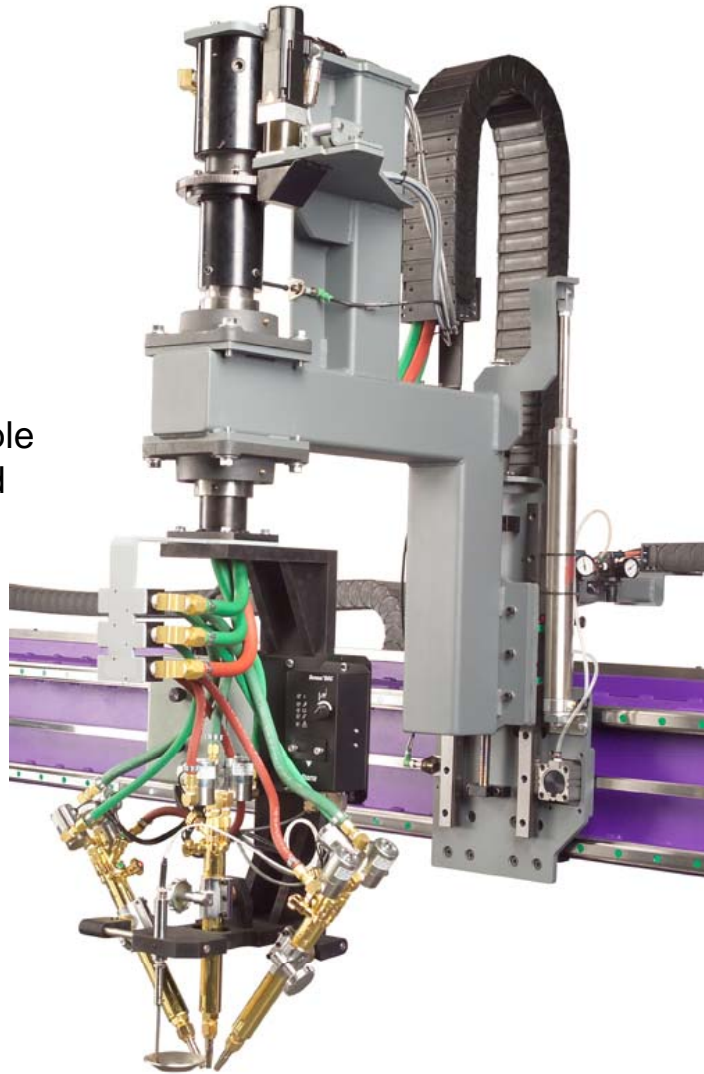

Thank you

